

GRIP HEATER

Accessory Name	Parts Number	Application Model	Issue Date	Publication No.	FRT
GRIP HEATER ATTACHMENT	08T70-K2E-J10	CT125A	2023.01	MII	1.0 H
GRIP HEATER	08T71-K2E-J10				

Introduction

ALL INFORMATION, ILLUSTRATIONS, DIRECTIONS AND SPECIFICATIONS INCLUDED IN THIS PUBLICATION ARE BASED ON THE LATEST PRODUCT INFORMATION AVAILABLE AT THE TIME OF APPROVAL FOR PRINTING. Honda Motor Co., Ltd. RESERVES THE RIGHT TO MAKE CHANGES AT ANY TIME WITHOUT NOTICE AND WITHOUT INCURRING ANY OBLIGATION WHATSOEVER. NO PART OF THIS PUBLICATION MAY BE REPRODUCED WITHOUT WRITTEN PERMISSION. THIS MANUAL IS WRITTEN FOR PERSONS WHO HAVE ACQUIRED BASIC KNOWLEDGE OF MAINTENANCE ON Honda MOTORCYCLES, MOTOR SCOOTERS OR ATVS.

Honda Dealer:





Please give a copy of these instructions to your customer.

Customer:

Because it requires specialized knowledge and special tools and equipment, it is recommended to install it at a dealer with qualified automobile maintenance.

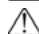
How To Read These Symbols

Your safety, and the safety of others, is very important. To help you make informed decisions we have provided safety messages and other information throughout this manual.

-  **WARNING** You CAN be KILLED or SERIOUSLY HURT if you don't follow instructions.
-  **CAUTION** You CAN be HURT if you don't follow instructions.
-  **NOTICE** The purpose of this message is to help prevent damage to your vehicle, other property, or the environment.
-  **NOTE** Things you want to know, things that are useful to know.
-  Follow the instructions of the Service Manual.
-  Follow the other symbol instructions of the "Installation Instructions BASIC".

Instruction Other Symbols

The symbols used throughout this instructions show specific service procedures. Refer to "Installation Instructions BASIC" for description of each symbol.

INFORMATION

⚠ CAUTION

- To prevent burns, allow the engine, exhaust system, radiator, etc., to cool before installing the accessory.

NOTICE

- **Be sure to observe the following when installing the Left Grip Heater.**
 - Do not tap on the grip end with a hammer and do not twist the grip to install the left grip heater onto the handlebar, as it can damage the element.

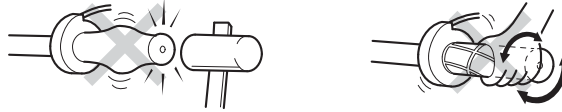

- If the grip gets stuck halfway during installation, apply isopropyl alcohol to the gap between the grip heater. Do not try to remove the grip heater using force or a screwdriver, etc. Damage to the grip heater wire can result.

NOTE:

- Disconnect the throttle cables from the right grip as instructed in the motorcycle's Service Manual.
- For secure adhesion of the grip heater use the recommended adhesive agent (Honda Bond A) or equivalent.
- Be sure to open and close the throttle to check for smooth operation after installation of the right grip heater.
- Take care not to damage the painted surfaces of the motorcycle.
- Save all removed parts unless otherwise indicated.
- Reinstall the removed parts on the motorcycle and make sure that the wires and harnesses are not pinched.
- After reconnecting the battery, refer to the motorcycle Owner's Manual and set the meter.
- Trim the excess ends off the wire ties after attaching them to the wire harnesses. Do not allow the cut part of the wire tie to interfere with another harness or brake hose.
- Move the handlebar right to left and check that the harnesses are not pinched by the neighboring components and that they are not too tight.
- After grip heater installation, check the lights (e.g. right / left turn signal lights and brake lights) for proper operation.

PARTS LIST

When the instruction manual and installation instructions are included in this kit, be sure to give them to the customer.

<GRIP HEATER ATTACHMENT>

Component	No.	Parts Name	Qty	Parts No.
	(1)	Switch bracket	1	-
	(2)	Collar (11 x 15 mm)	2	-
	(3)	Socket bolt (6 x 40 mm)	2	96600-0604007
	(4)	Screw (3 x 12 mm)	2	93901-12380
	(5)	Spacer	2	-
	(6)	Sub harness	1	-
	(7)	Screw (6 x 50 mm)	2	90126-MJ4-700
	(8)	Wire tie (4.9 x 250 mm)	4	-
	(9)	Heater switch	1	35300-MCS-G51
	(10)	Washer	2	94101-06700

<GRIP HEATER>

Component	No.	Parts Name	Qty	Parts No.
	(11)	Right grip heater	1	08T00-K2E-J11
	(12)	Left grip heater	1	08T01-K2E-J11

SYSTEM DIAGRAM

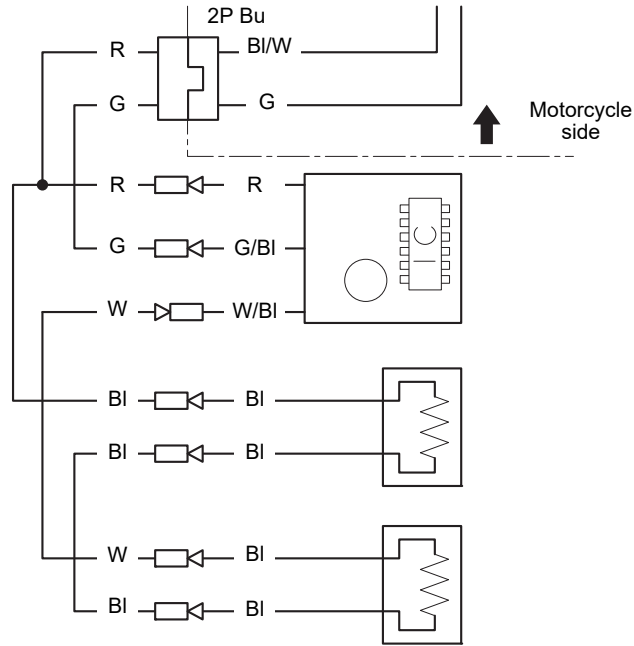

Identify wire colors:
 BI: Black
 Bu: Blue
 G: Green
 R: Red
 W: White

TORQUE INFORMATION

ITEM	N·m (kgf·m)
Screw (3 x 12 mm)	9 (0.9)
Socket bolt (6 x 40 mm)	10 (1.0)

Refer to the Service Manual for the torque values including standard torque of the removed parts. (M)

INSTALLATION

1. Refer to the Service Manual for the motorcycle, remove the motorcycle parts as shown, and disconnect the negative (-) cable from the battery. (📖)

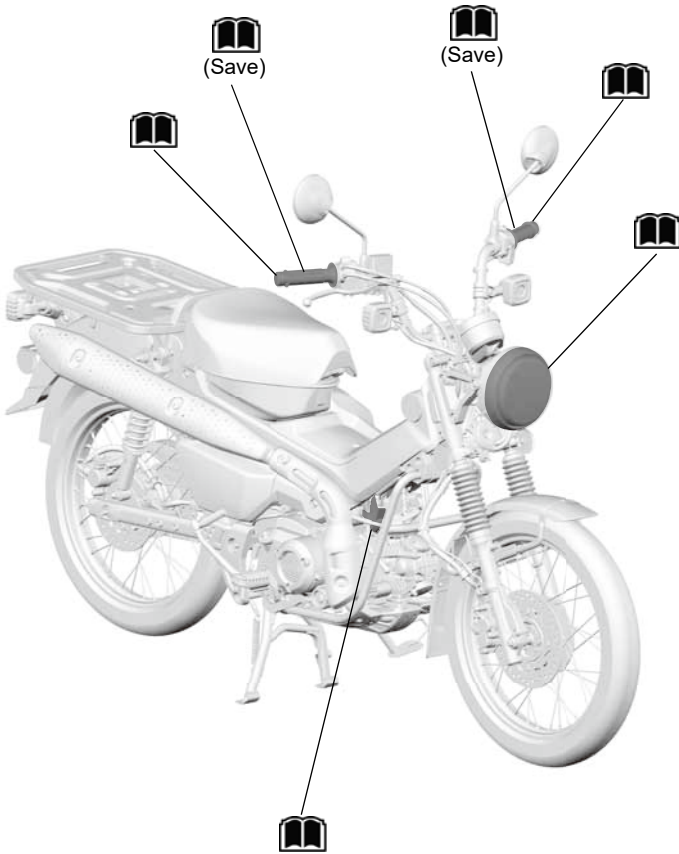

INSTALLATION IMAGE

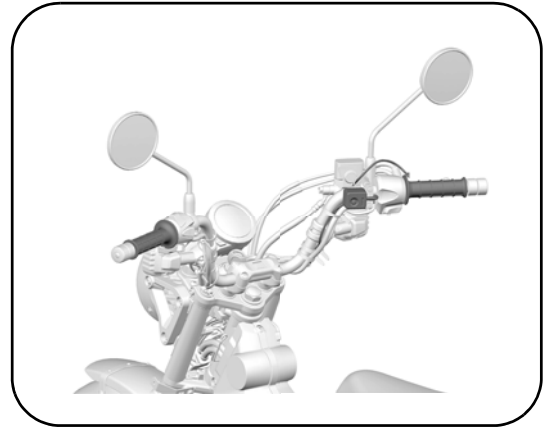

2. Mark in the position shown.

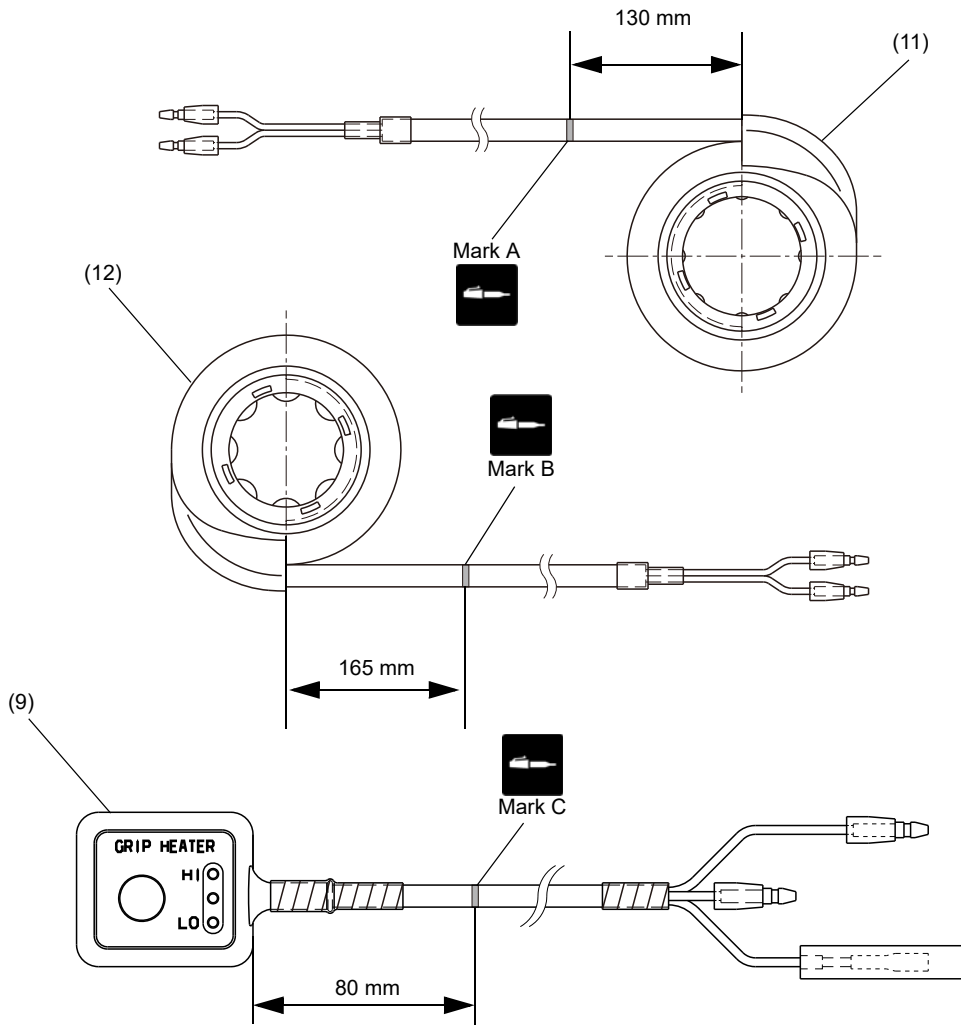

3. Remove as shown.

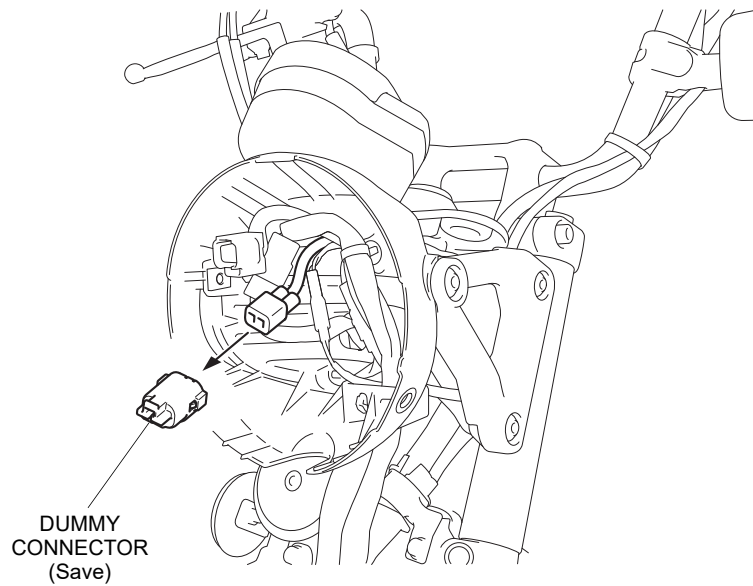

4. Install as shown.
- Be sure to check the content of the notice (page 2).

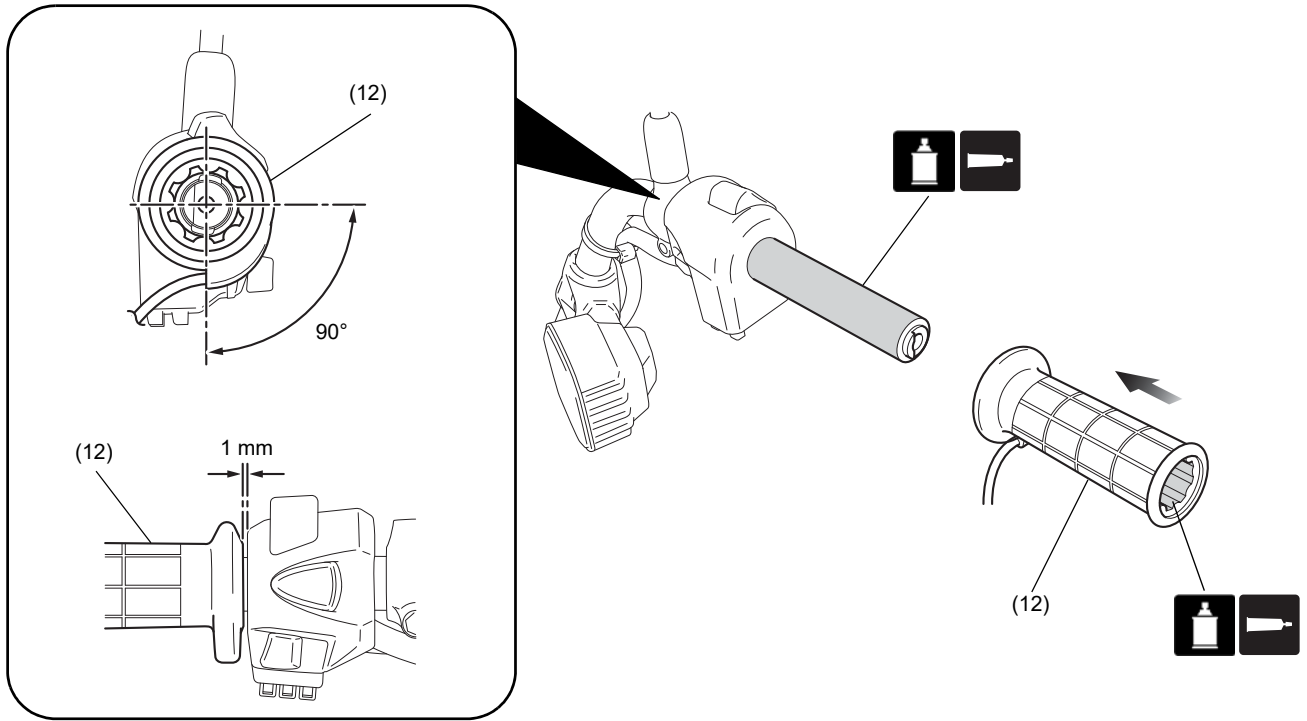

5. Refer to the Service Manual for the motorcycle, apply the grease, and install the right grip heater and throttle housing in the reverse order of the motorcycle's grip removal.
- After installation, refer to the Service Manual and adjust the throttle freeplay.

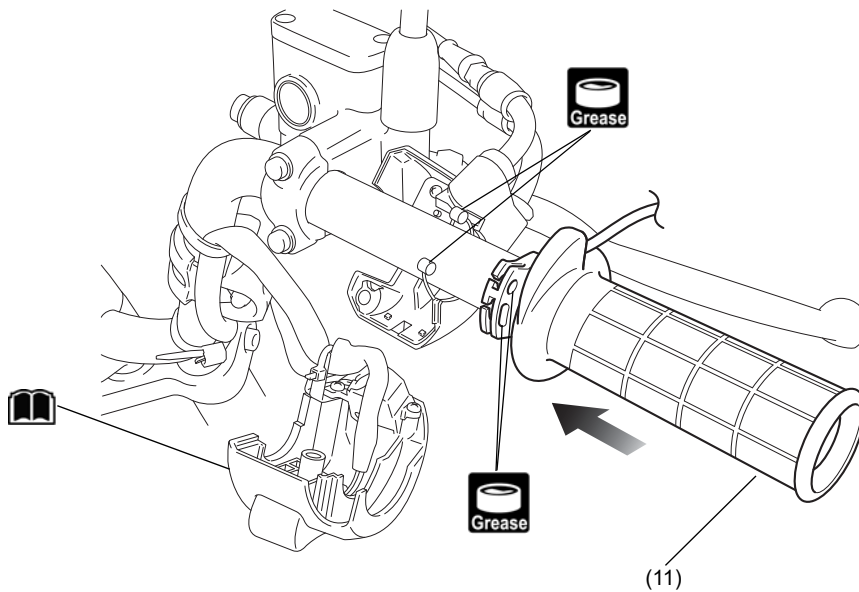

6. Install as shown.

Left side shown:

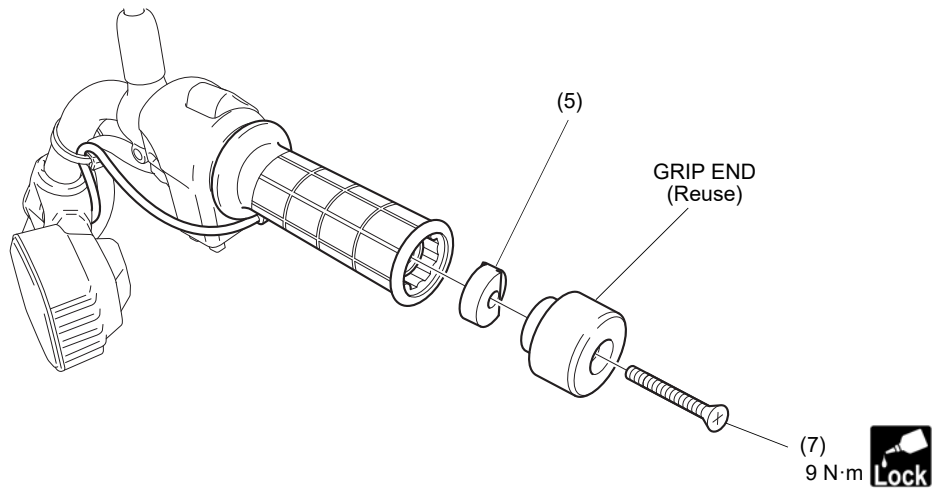

7. Install as shown.

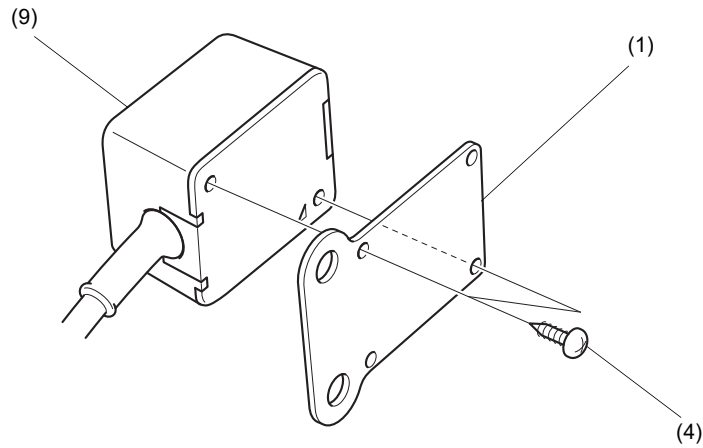

8. Remove as shown.

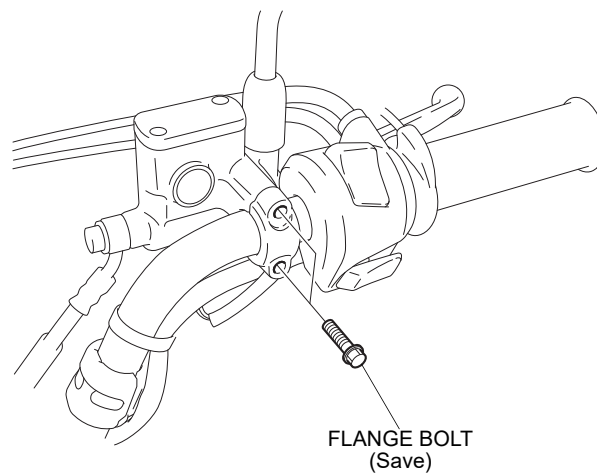

9. Install as shown.
 • First tighten the upper bolt, then tighten the lower bolt.

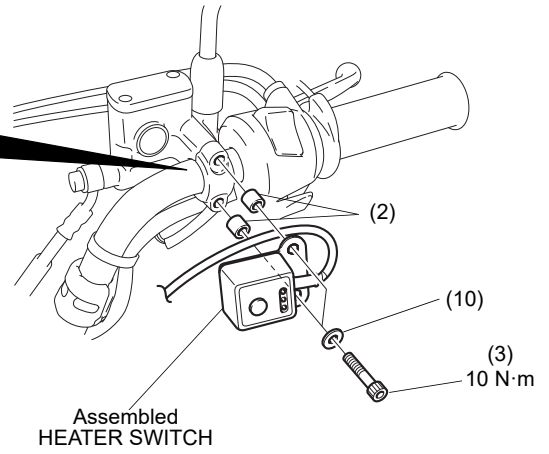
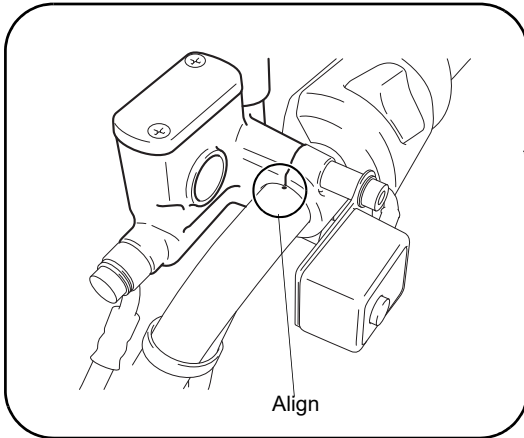

10. Route the harness as shown.
 • Open and close the throttle and check that the grip heater harness is not pulled or caught on the projections.

Right side:

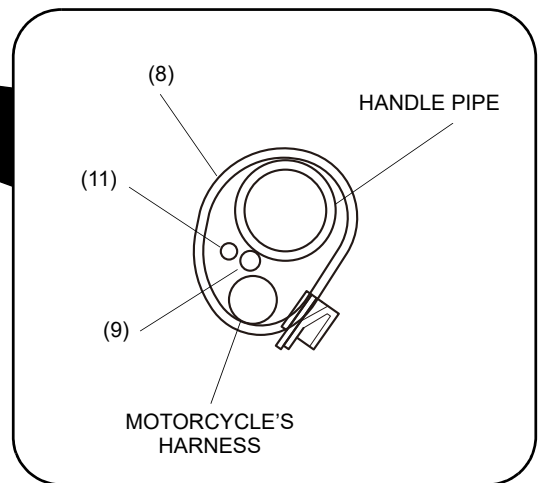
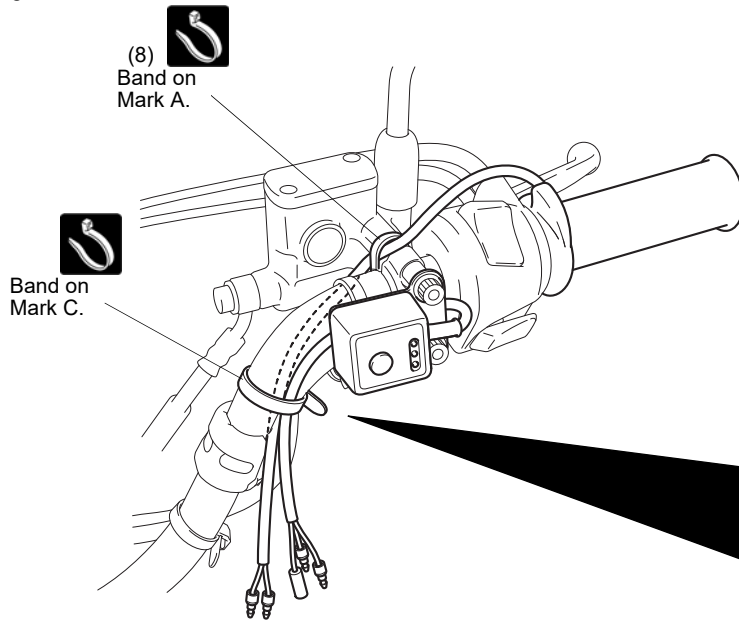

11. Route the harness as shown.

Left side:



Band on Mark B.

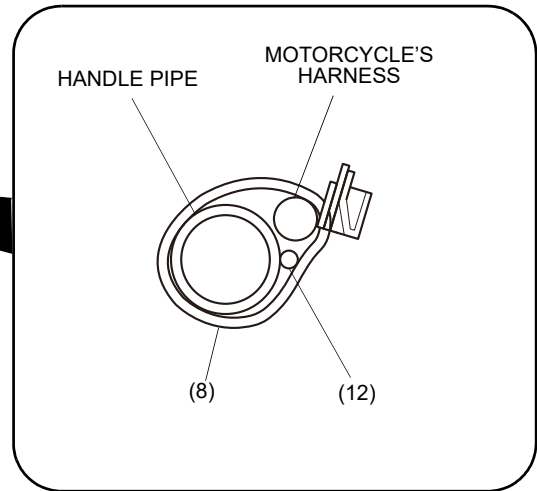
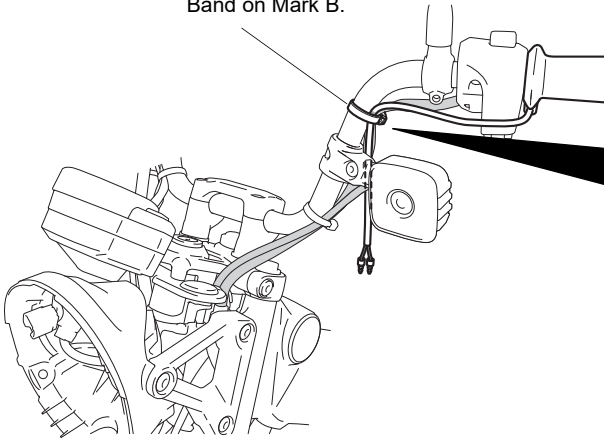

12. Route the harness as shown.

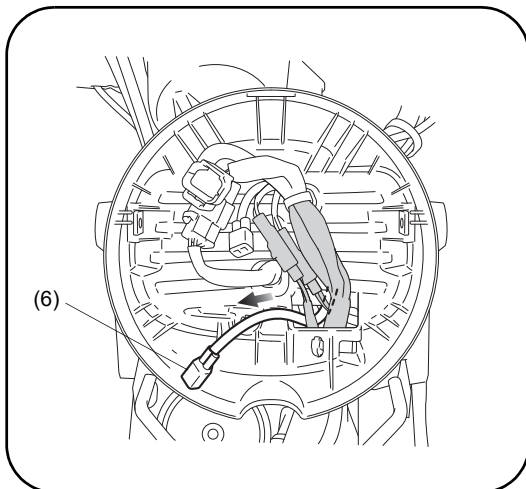

13. Route the harness as shown.

Right side:

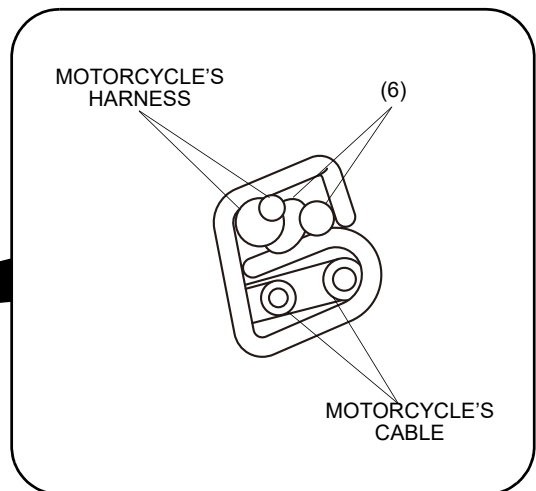
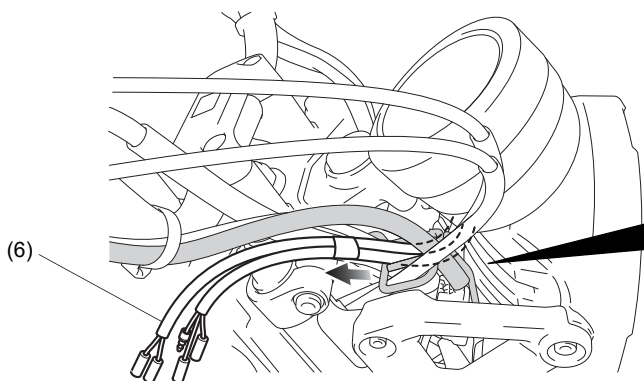

14. Route the harness as shown.

Left side:

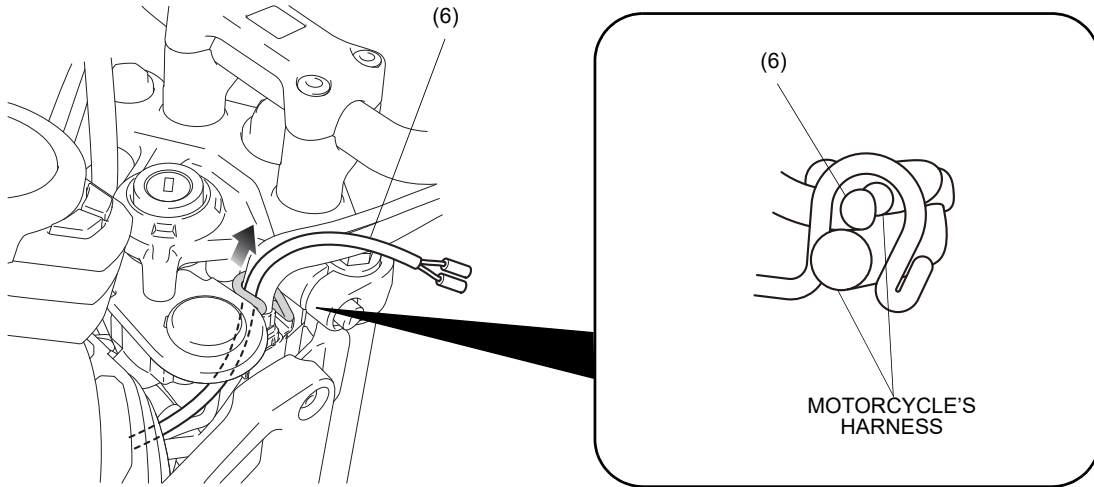

15. Route the harness as shown.

Right side:

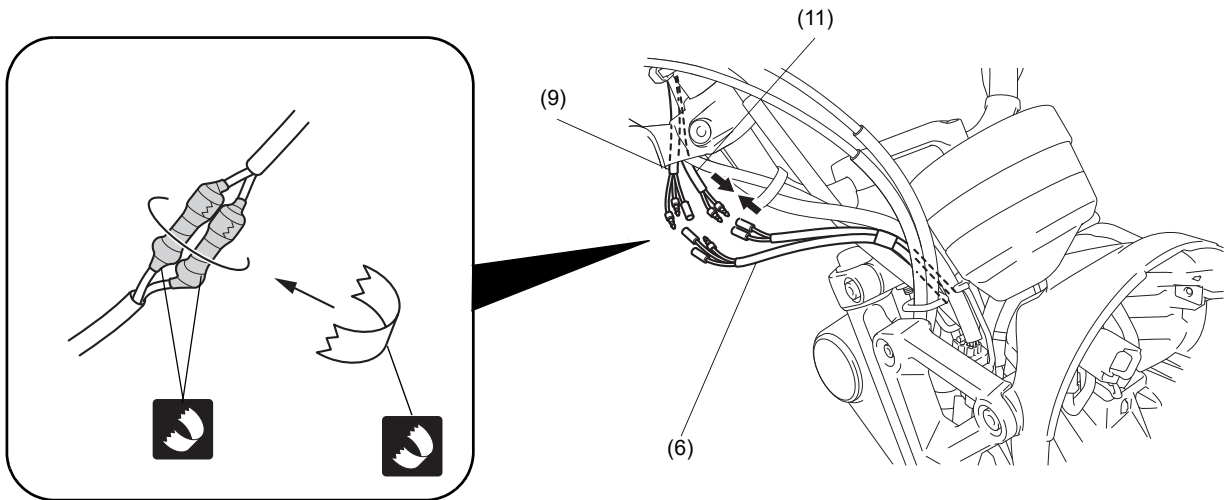

16. Route the harness as shown.

Right side:

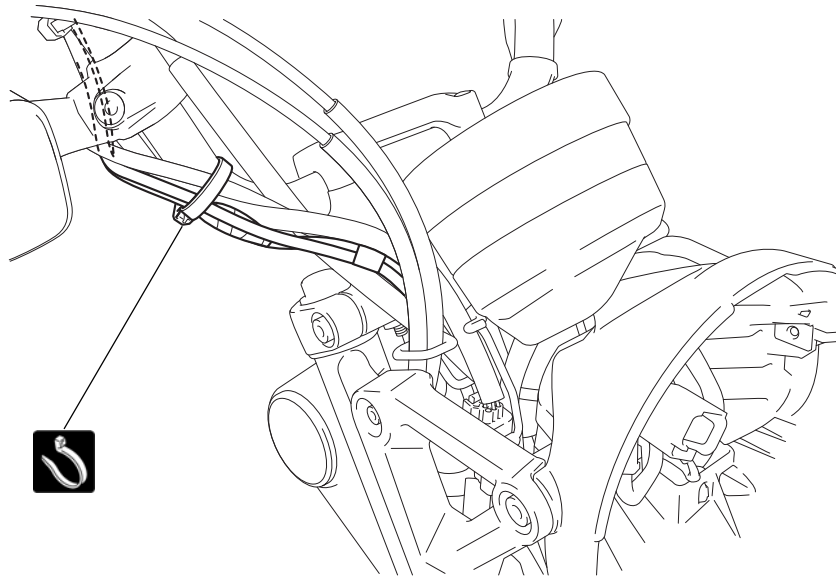

17. Route the harness as shown.

- Open and close the throttle and check that the grip heater harness is not pulled or caught on the projections.

Right side:

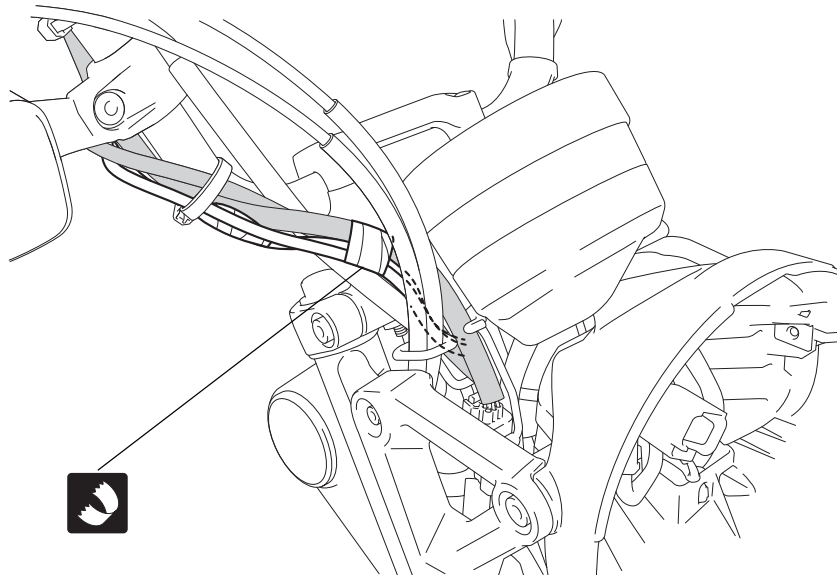

18. Route the harness as shown.

Left side:

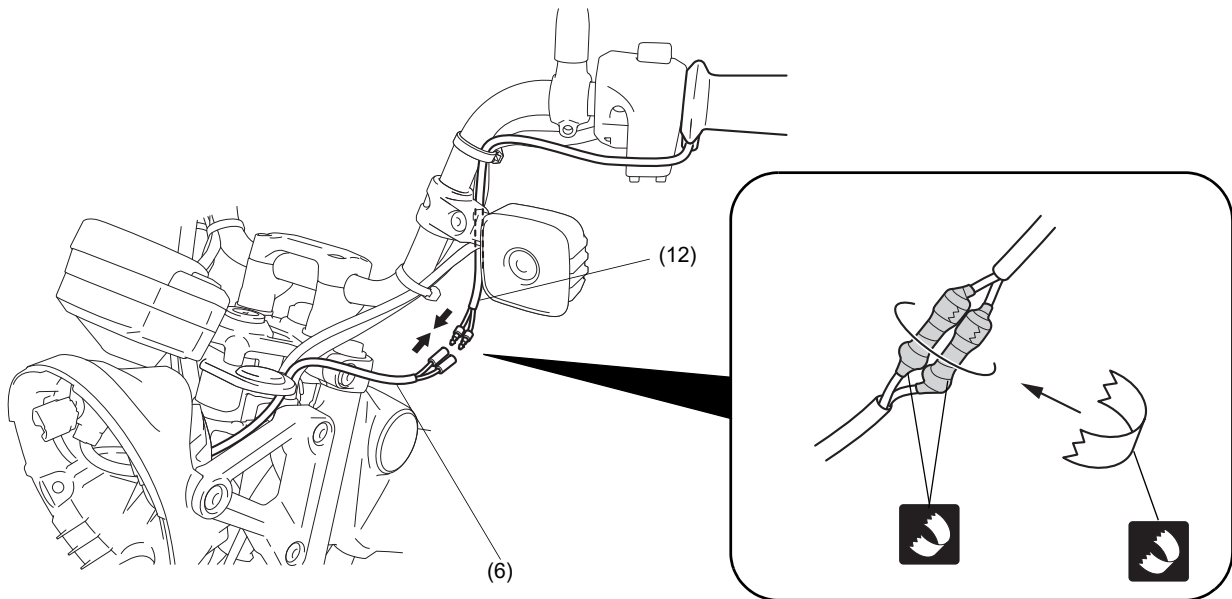

19. Route the harness as shown.

Left side:

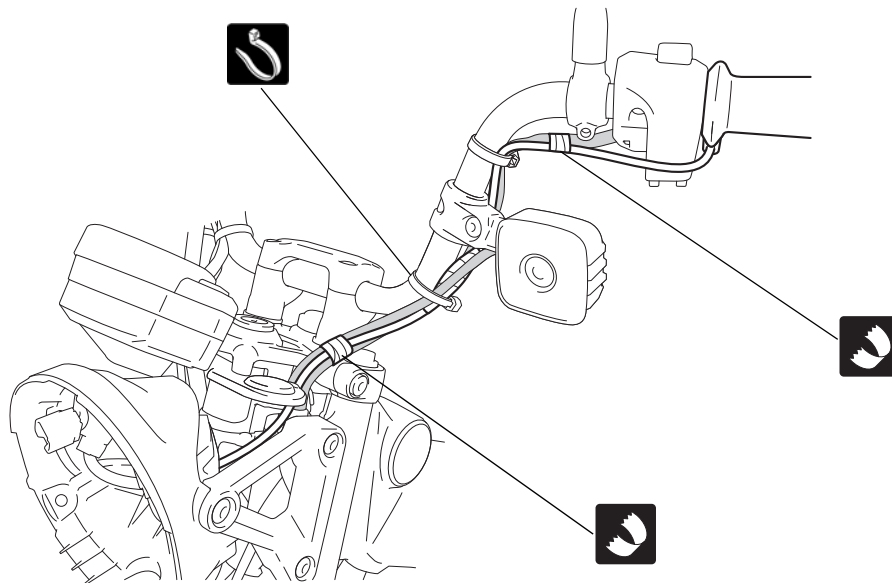

20. Route the harness as shown.

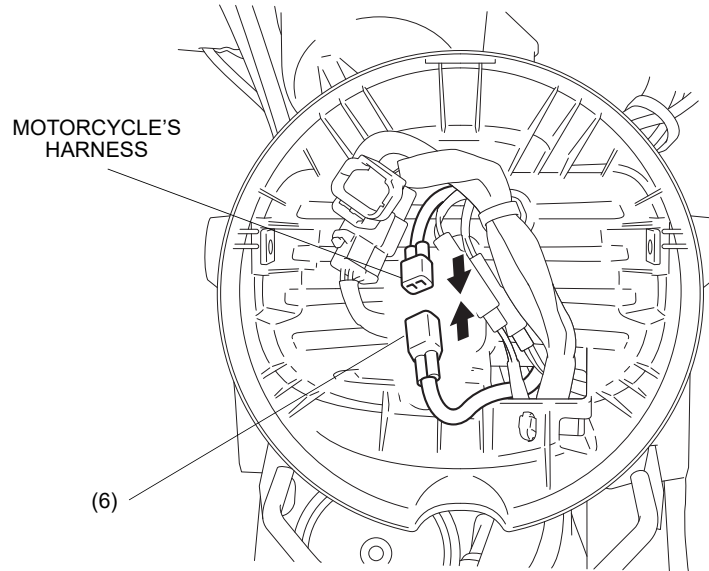

21. Install the motorcycle's parts in the reverse order of removal.
• Confirm that any harness is not caught or too tight.

DEALER TROUBLESHOOTING

- Stop the engine and turn the ignition switch OFF when you check the parts and circuits other than those of the grip heaters.

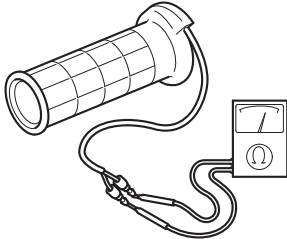
Symptom	Check
<p>Grip heater does not operate;</p> <ul style="list-style-type: none"> • Faulty grip heater • Faulty grip heater coil • Faulty grip heater switch • Open or short circuit in heater harness 	<ol style="list-style-type: none"> 1. Check whether wires and cables (terminals and connectors) are connected securely. 2. Grip heater inspection Check for resistance between the terminals. <ul style="list-style-type: none"> ⇒ Standard: Right : 5.5 Ω +/- 10% Left : 5.5 Ω +/- 10%  <ol style="list-style-type: none"> 3. Heater harness inspection: Check for continuity. 4. If no abnormality is found after the above checks 1, 2, and 3, but the grip heater still does not operate properly, replace the grip heater with a new one. <ul style="list-style-type: none"> • It is hard to check the switch with ordinary inspection methods (for continuity, voltage, etc.) because it contains an integrated circuit.
<p>The indicator does not stop blinking.</p>	<ol style="list-style-type: none"> 1. Refer to the Service Manual for the motorcycle, inspect the charging system and battery.